

STANDARD MATERIAL SPECIFICATIONS FOR MODEL #CBA/#CCA

(ACC. TO ASTM)

PART NAME	CARBON STEEL		LOW-TEMP. CARBON STEEL		STAINLESS STEEL	
	NORMAL	SOUR	NORMAL	SOUR		
BODY	A216 Gr. WCB		A352 Gr. LCC		A351 Gr. CF8M	
CAP	A216 Gr. WCB		A352 Gr. LCC		A351 Gr. CF8M	
BALL	A216 Gr. WCB		A351 Gr. CF8M		A351 Gr. CF8M	
STEM	A216 Gr. WCB		A276 TYPE 316		A276 TYPE 316	
SEAT	CLASS 150,300	RTFE				
	CLASS 600	S - NYLON	S - PE / PCTFE		S - NYLON	
PACKING	GRAPHITE					
GASKET	PTFE / GRAPHITE / SW(316+GRAPHITE)					
ISO PAD	A216 Gr. WCB		A352 Gr. LCC		A351 Gr. CF8	
STEM SEAL RETAINER	A216 Gr. WCB		A276 TYPE 316		A276 TYPE 316	
O - RING	VITON					
STOPPER	A283 Gr. D			A240 TYPE 304		
BEARING	CLASS 150,300	PTFE				
	CLASS 600	NYLON	S - PE		NYLON	
BOLT	A193 Gr. B7	A193 Gr. B7M	A320 Gr. L7	A320 Gr. L7M	A193 Gr. B8	
LEVER	DUCTILE CAST IRON					
GEAR OPERATOR	CAST IRON CASE, DUCTILE IRON GEAR, HIGH CARBON STEEL WORM					

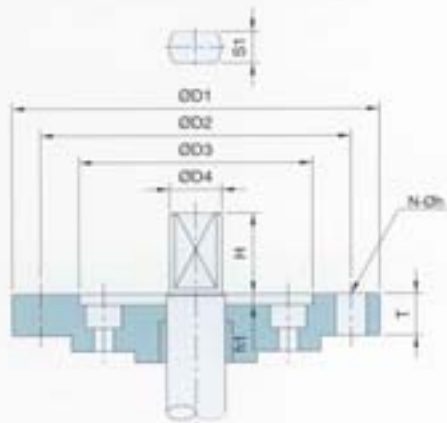

ISO 5211 MOUNTING PAD FOR ACTUATOR SELECTION (UNIT : mm , N-m)

ISO 5211 MOUNTING TORQUE FROM Mm	D1	D2	D3	CC				
				150	300	600	600	
F04	63	56	42	30	3/4"	3/4"	3/4"	3/4"
F05	125	65	50	35	1 1/2"	1 1/2"	1 1/2"	1 1/2"
F07	250	90	70	55	2,2"	2,3"	2,3"	2,3"
F10	500	125	102	70	4"	4,6"	4,6"	4"
F12	1,000	150	125	85	6"	8"	8"	6"
F14	2,000	175	140	100	8"	10"	10"	8"

VOID

See attached sheet on this disc for the updated mounting pad information.

FLOW COEFFICIENT (Cv) FOR MODEL #CBA/#CCA

VALVE SIZE	1/2"	3/4"	1"	1 1/2"	2"	2 1/2"	3"	4"	6"	8"	10"
CBA	25	50	95	260	480	760	1300	2300	5550	10080	16300
CCA	-	-	-	-	120	-	311	535	1112	1908	- 0

Cv = FLOW IN U'S' GALLONS/MINUTE OF 60°F WATER

API 6D TEST

CLASS	150# Hydrostatic						300# Hydrostatic						600# Hydrostatic						900# Hydrostatic						1500# Hydrostatic						SEAT (As) Type I	TEST SIZE	Duration(minutes)		
	W.P		SHELL		SEAT		W.P		SHELL		SEAT		W.P		SHELL		SEAT		W.P		SHELL		SEAT		W.P		SHELL		SEAT				Hydrostatic	Dr	Dr
	D99	psig	kg/w	psig	kg/w	psig	kg/w	D99	psig	kg/w	psig	kg/w	D99	psig	kg/w	psig	kg/w	D99	psig	kg/w	psig	kg/w	D99	psig	kg/w	psig	kg/w	D99	psig	kg/w					
A105/WCB /LF2	285	450	31.7	325	22.9	740	1125	79.2	825	58.1	1480	2225	157	1650	116	2220	3350	236	2450	172	3705	5575	392	4100	289	10"	2	2	2						
LCC	290	450	31.7	325	22.9	750	1125	79.2	825	58.1	1500	2225	158	1650	116	2250	3375	238	2475	174	3750	5625	396	4125	290	6"	5								
LCB	265	400	28.1	300	21.1	895	1050	73.9	775	54.5	1390	2100	148	1550	109	2085	3150	222	2300	162	3470	5225	368	3825	269	12"	15	5	5						
F316/CF3 /CF8/CF8M	275	425	29.9	325	22.9	720	1100	77.4	800	56.3	1440	2175	153	1600	113	2160	3250	229	2400	169	3600	5400	380	3975	280	≥ 20"	30								